

# OBLIQUE 225 22 LED

## HOUSING

THE SLEEK 2.25" DEEP LED HOUSING WILL FIT INTO 95% OF EXISTING CEILINGS, FORMED FROM 20GA CRS MATERIAL. FINISH: WHITE (STANDARD) POWDER COATED ALL FIXTURES ARE PRE-WIRED. ALL STEEL PARTS ARE PHOSPHATE TREATED FOR CORROSION RESISTANCE BEFORE PAINT PROCEDURE, THEN BAKED WITH SUPERIOR ADHESION FOR DURABILITY.

## LED MODULES

MID POWER FR4 LED LM79/LM80 (INSTALLED 3000K, 3500K, 4000K)  
2 LIGHT CROSS SECTION LED ARRAY

## DRIVERS

LED ELECTRONIC DRIVER (POWER SUPPLY)  
VOLTAGE: 120V-277V (UNIVERSAL)  
CLASS 2 HIGH EFFICIENCY DRIVER  
UL RECOGNIZED AND ROHS COMPLIANCE

## REFLECTOR

ARCHITECTURALLY DESIGNED HIGHLY EFFICIENT 20 GAUGE STEEL REFLECTOR FINISHED IN A ECO-LED POWDER TO ELIMINATE ANY HOT SPOTS OR STRIATIONS. THE RABBETED REFLECTOR/PLASTIC EDGE PROVIDES UNINTERRUPTED LIGHT ACROSS THE SURFACE.

## MOUNTING

15/16" GRID (T), SLOT GRID (DFL), 9/16"GRID (T1), FLANGE

## PRODUCT DESCRIPTION

THE OBLIQUE 225 MEETS TODAY'S ILLUMINATION REQUIREMENTS SET BY ARCHITECTS, ENGINEERS, LIGHTING CONSULTANTS AND UTILITIES IN A **COMPETITIVE SHALLOW 2.25" HIGH PERFORMANCE MODE**. CONTEMPORARY STYLING AND SUPERIOR ENERGY SAVINGS DEFINE THE UNIT. *THE ELLIPTICAL EXTRUDED CENTER SUBTLE LENS DESIGN PROVIDES OPTIMAL GLARE CONTROL WHILE SHEDDING UNIFORM LIGHT ACROSS THE FACE OF THE FIXTURE*. THE SATIN WHITE EXTRUDED DIFFUSER ILLUMINATES THE SPACE WITHOUT ANY HOT SPOTS OR STRIATIONS. TONGUE AND GROOVE CONSTRUCTION BETWEEN THE CENTER LENS AND REFLECTOR IS SEAMLESS. THE 2.25" DEPTH IS COMPLETELY PLENUM FRIENDLY AND A TRACK ANSWER FOR PROJECTS REQUIRING LED CHANGEOVERS.

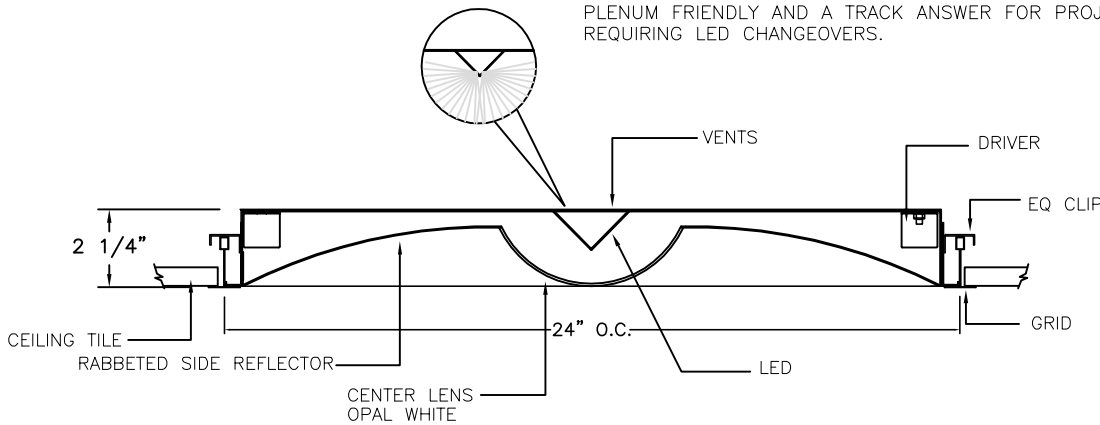

## CEILING OPTIONS

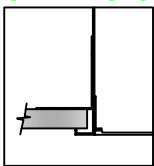

FLANGE (F)

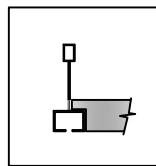

SLOT GRID (SG)

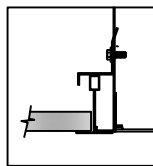

GRID (T)

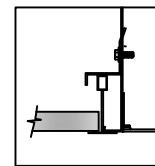

9/16"GRID (T1)

## ORDERING KEY

SERIES	LUMENS / (W)	COLOR TEMP	CEILING TYPE	VOLTAGE	OPTIONS
OBLQ225	<input type="checkbox"/> LO 2259 (23) <input type="checkbox"/> MO 3623 (35) <input type="checkbox"/> HC 4262 (41)	<input type="checkbox"/> 2700K* <input type="checkbox"/> 3000K <input type="checkbox"/> 3500K <input type="checkbox"/> 4000K <input type="checkbox"/> 5000K	<input type="checkbox"/> T <input type="checkbox"/> F <input type="checkbox"/> SG <input type="checkbox"/> T1	<input type="checkbox"/> 120 V <input type="checkbox"/> 277 V <input type="checkbox"/> UNIVERSAL	<input type="checkbox"/> EM <input type="checkbox"/> DIM 0-10 <input type="checkbox"/> DALI <input type="checkbox"/> L3DA 3WireorEco1% <input type="checkbox"/> LDE1 - Eco1% <input type="checkbox"/> TAILS <input type="checkbox"/> SENSOR(OCC/VAC)

LUMENS WILL VARY DEPENDING ON DIFFUSER AND LED COLOR TEMP.

NATIONAL 3E/LED SERIES USES ENGINE/STICK ORIGINAL EQUIPMENT (BY OSRAM, PHILIPS, SAMSUNG, ET AL) WHICH ARE RATED FOR APPROXIMATELY 100 LM/W. ARCHITECTURAL LENSES PROVIDED WITH THE LUMINAIRES BY DESIGN EVEN THE BRIGHTNESS AND VISUAL COMFORT AND MIGHT FRACTIONALLY LOWER LM/W.



## TYPE:

## PROJECT:

EVEN AND VISUALLY COMFORTABLE LED LIGHT DISTRIBUTION ACROSS PROFILE OF THE PRODUCT

50% ENERGY SAVINGS COMPARED TO LINEAR FLUORESCENT

SUSTAINABLE MATERIALS

ARRAY OF LUMEN OPTIONS ALL LM79/LM80 UL APPROVED

5 YEAR WARRANTY LED AND DRIVER

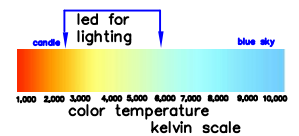

522 CORTLANDT ST.  
BELLEVILLE, NJ 07109

NJ 973-751-1600  
NY 212-751-1600  
FAX 973-751-4931  
WWW.NATLTG.COM

