

NICHE 2NR LED

HOUSING

TO BE FORMED FROM 20GA CRS
FINISH: ECO WHITE (STANDARD)
ALL STEEL PARTS ARE PHOSPHATE
TREATED FOR CORROSION RESISTANCE
BEFORE PAINT PROCEDURE, THEN
BAKED WITH SUPERIOR ADHESION
FOR DURABILITY

LED MODULES

HIGHER EFFICACY UP TO 170 LPW
WITH SERVICE LIFE GREATER THAN
60000(L70) HIGH COLOR RENDER AND
EXCELLENT COLOR CONSISTENCY
COLOR OPTIONS AVAILABLE FROM
27K TO 40K .

90 CRI LEDS AVAILABLE AS OPTIONAL

DRIVERS

CONSTANT CURRENT, CLASS 2
UNIVERSAL INPUT : 120-277VAC
SOUND RATED A, 54V OUTPUT 0-10V
DIMMING STANDARD .
DALI, ECOSYSTEM AND DMX DRIVERS
ALSO AVAILABLE

REFLECTOR

TO BE FORMED FROM 20GA CRS
FINISH: BAKED WHITE ENAMEL WITH
90% REFLECTIVITY

MOUNTING

FLANGE, SLOT GRID
FLANGELESS, 15/16 GRID(T)
9/16 GRID(T1)

PRODUCT DESCRIPTION

THE 2NR LED COMBINES DIGITAL LIGHTING WITH A
UNIQUE APPROACH TO LINEAR RECESSED LIGHTING.
THE ADVANCED DESIGN OF THE 2NR LED OFFERS
60,000 HOURS LIFE. EXCELLENT COLOR AND CONTINUOUS
UNINTERRUPTED LIGHT WITHOUT SHADOWS. THE 2"
NOMINAL WIDE FIXTURE COMBINED WITH A LED LIGHT
SOURCE PROVIDES AESTHETICS AND ENERGY EFFICIENCY

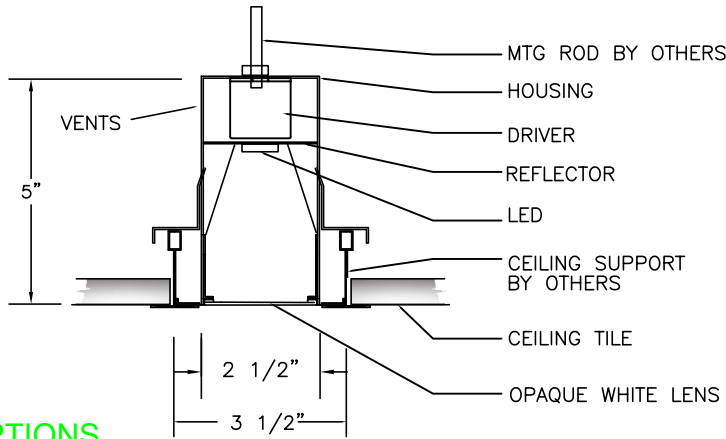
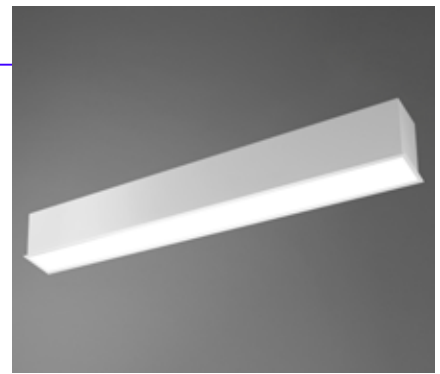

CEILING OPTIONS

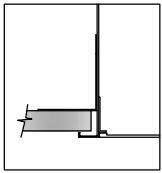

FLANGE(F)

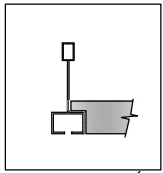

SLOT GRID(SG)

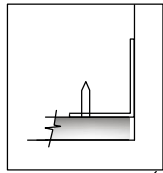

FLANGELESS(FO)

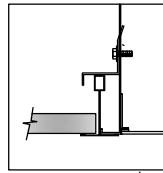

GRID 15/16(T)

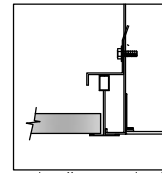

9/16"GRID (T1)

ORDERING KEY

SERIES	Lumens/ft (Watts/ft)	LENGTH	COLOR TEMP	CEILING TYPE	VOLTAGE	OPTIONS
NICHE 2NR LED	<input type="checkbox"/> LO 639(5.97)	<input type="checkbox"/> 2'	<input type="checkbox"/> 2700K*	<input type="checkbox"/> T1 9/16	<input type="checkbox"/> 120 V	<input type="checkbox"/> EM
	<input type="checkbox"/> MO 894.75(8.9)	<input type="checkbox"/> 3'	<input type="checkbox"/> 3000K	<input type="checkbox"/> T	<input type="checkbox"/> 277 V	<input type="checkbox"/> 0-10V
	<input type="checkbox"/> HO 1080(10.5)	<input type="checkbox"/> 4'	<input type="checkbox"/> 3500K	<input type="checkbox"/> F	<input type="checkbox"/> UNIVERSAL	<input type="checkbox"/> DALI
		<input type="checkbox"/> 6'	<input type="checkbox"/> 4000K	<input type="checkbox"/> SG		<input type="checkbox"/> EcoSystem, 2 WIRE
		<input type="checkbox"/> 8'	<input type="checkbox"/> 5000K	<input type="checkbox"/> FO		<input type="checkbox"/> L3DA-3Wire or Eco1%
		<input type="checkbox"/> ROWS				<input type="checkbox"/> LDE1 - Eco1%
						<input type="checkbox"/> SENSOR(OCC/VAC)

LUMENS WILL VARY SLIGHTLY DEPENDING ON
DIFFUSER AND LED COLOR TEMP. PLEASE
CONSULT NATIONAL FOR 2700K AND 90CRI LEDS

NATIONAL 3E/LED SERIES USES ENGINE/STICK ORIGINAL EQUIPMENT (BY OSRAM, PHILIPS,
SAMSUNG, ET AL) WHICH ARE RATED FOR APPROXIMATELY 100 LM/W. ARCHITECTURAL
LENSES PROVIDED WITH THE LUMINAIRES BY DESIGN EVEN THE BRIGHTNESS AND VISUAL
COMFORT AND MIGHT FRACTIONALLY LOWER LMWT.

TYPE:

PROJECT:

EVEN AND VISUALLY
COMFORTABLE LED
LIGHT DISTRIBUTION
ACROSS PROFILE OF
THE PRODUCT

50% ENERGY
SAVINGS COMPARED
TO LINEAR
FLUORESCENT

SUSTAINABLE
MATERIALS

ARRAY OF LUMEN
OPTIONS ALL
LM79/LM80 UL
APPROVED

5 YEAR WARRANTY
LED AND DRIVER

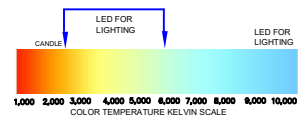

522 CORTLANDT ST.
BELLEVILLE, NJ 07109

NJ 973-751-1600
NY 212-751-1600
FAX 973-751-4931
WWW.NATLTG.COM

Modules and drivers are UL recognized
components and RoHS compliant.
LED modules also comply with IENSA
LM-79 and LM-80 standards.



PHOTOMETRIC DATA

2NR LED-LO

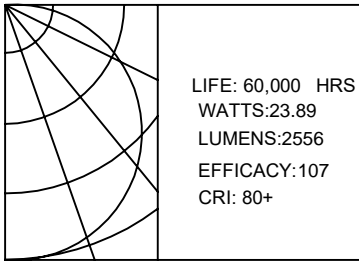

2NR LED-MO

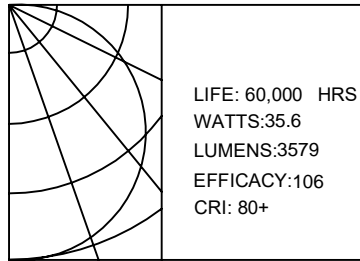

2NR LED-HO

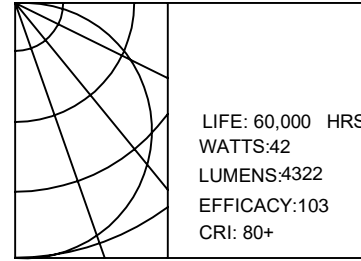

All values are based on 4' Section.

MOUNTING INSTRUCTIONS

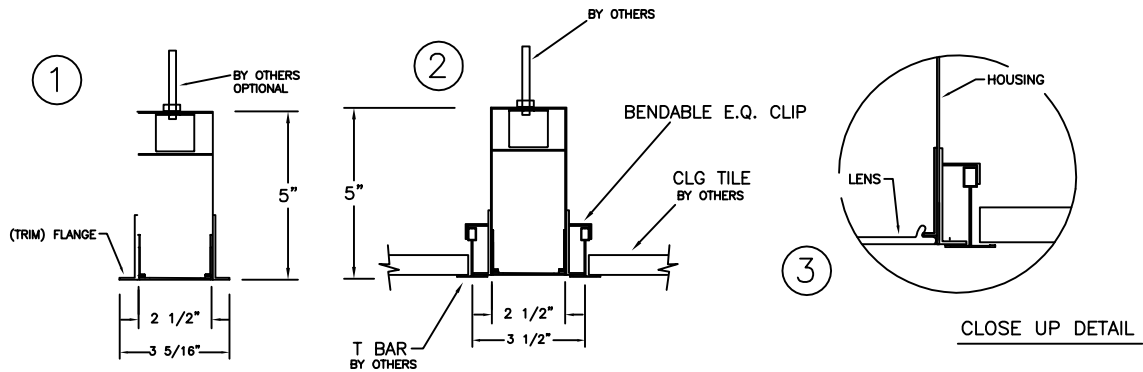

HOW TO REMOVE LENS

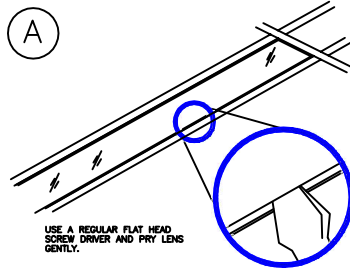

HOW TO INSTALL LENS

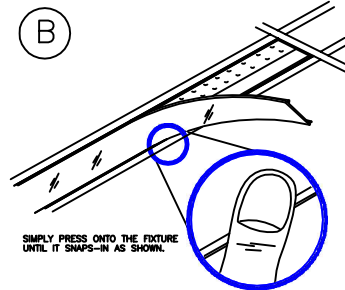

LIGHTING CONTROL SOLUTIONS

- DIMMING (0-10V, DALI Or Lutron)**
 - 0-10V Dimming Driver used as standard.
 - Continuous Dimming up to 10%.
 - Dimming wires not provided unless specified
 - Contact National for Dali or Lutron Control system
- Occ/DAYLIGHT/Vacancy/Bi-Level**
 - Sensor-ready and compatible drivers provided.
 - Sensors can be field installed or could be installed in the fixtures
 - Bi-level dimming and Motion sensors also available
- Compatibility:**

National fixtures are compatible with Lutron, Philips Actilume, Magnum, Wattstopper, Hubbell , Leviton , Hytronik , Daintree & Enlighted Control System

CORNER DETAIL

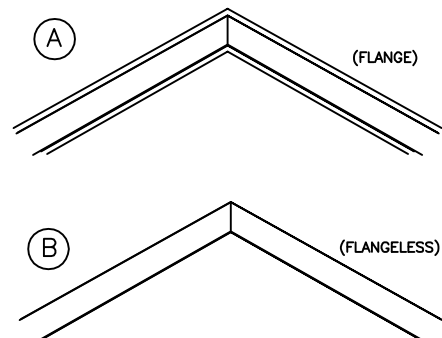

NATIONAL LIGHTING COMPANY, INC.
522 CORTLANDT ST.
BELLEVILLE, NJ 07109

NJ 973-751-1600
NY 212-751-1600
FAX 973-751-4931
WWW.NATLTG.COM

JOB NAME:
CATALOG:
TYPE: