

AFFINE 2x2 LED

HOUSING

TO BE FORMED FROM 20GA CRS
FINISH: ECO WHITE (STANDARD)
ALL STEEL PARTS ARE PHOSPHATE
TREATED FOR CORROSION RESISTANCE
BEFORE PAINT PROCEDURE, THEN
BAKED WITH SUPERIOR ADHESION
FOR DURABILITY

LED MODULES

HIGHER EFFICACY UP TO 170 LPW
WITH SERVICE LIFE GREATER THAN
60000(L70) HIGH COLOR RENDER AND
EXCELLENT COLOR CONSISTENCY
COLOR OPTIONS AVAILABLE FROM
27K TO 40K .
90 CRI LEDES AVAILABLE AS OPTIONAL

DRIVERS

CONSTANT CURRENT, CLASS 2
UNIVERSAL INPUT : 120-277VAC
SOUND RATED A, 54V OUTPUT 0-10V
DIMMING STANDARD .
DALI, ECOSYSTEM AND DMX DRIVERS
ALSO AVAILABLE

REFLECTOR

TO BE FORMED FROM 20GA CRS
FINISH: BAKED WHITE ENAMEL WITH
90% REFLECTIVITY

MOUNTING

FLANGE, SLOT GRID
FLANGELESS, 1⁵/₁₆ GRID(T)
9¹/₁₆ GRID(T1)

PRODUCT DESCRIPTION

THE AFFINE LED 2'X2' COMBINES DIGITAL LED LIGHTING WITH HIGH PERFORMANCE AFFINE OPTICAL DESIGN. THE ADVANCE DESIGN OF THE LED AFFINE 2X2 OFFERS HIGH EFFICIENCY, 60000 HOURS OF LIFE AND EXCELLENT COLOR FOR GENERAL AND AMBIENT LIGHTING APPLICAITONS. THE LINEAR INTEGRAL PRISMS OF THE TRANSLUCENT LENS DISTRIBUTES LIGHT EVENLY INTO THE SPACE WHILE MINIMIZING CONTRAST BETWEEN THE FIXTURE AND CEILING

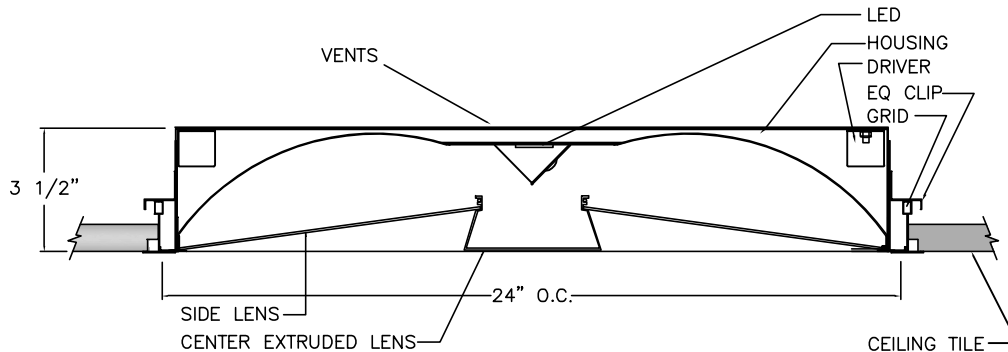
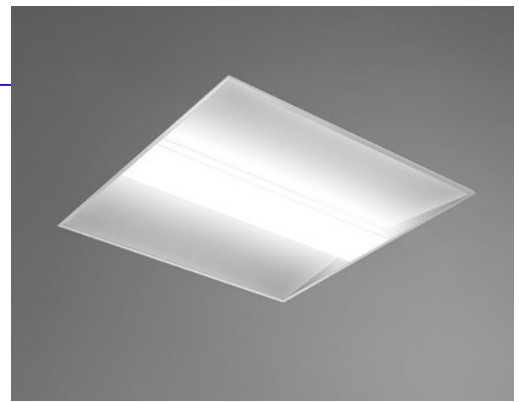

TYPE:

PROJECT:

EVEN AND VISUALLY
COMFORTABLE LED
LIGHT DISTRIBUTION
ACROSS PROFILE OF
THE PRODUCT

50% ENERGY
SAVINGS COMPARED
TO LINEAR
FLUORESCENT

SUSTAINABLE
MATERIALS

ARRAY OF LUMEN
OPTIONS ALL
LM79/LM80 UL
APPROVED

5 YEAR WARRANTY
LED AND DRIVER

CEILING OPTIONS

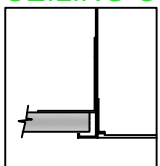

FLANGE(F)

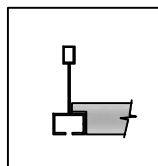

SLOT GRID(SG)

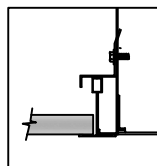

GRID (T)

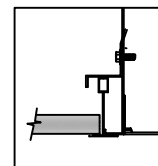

9/16"GRID (T1)

ORDERING KEY

SERIES	LUMENS (WATTS)	COLOR TEMP	CEILING TYPE	VOLTAGE	OPTIONS
AFF22LED	<input type="checkbox"/> LO 2457 (26) <input type="checkbox"/> MC 3520 (38) <input type="checkbox"/> HO 4256 (45.02) Please contact National for other options.	<input type="checkbox"/> 2700K** <input type="checkbox"/> 3000K <input type="checkbox"/> 3500K <input type="checkbox"/> 4000K <input type="checkbox"/> 5000K Contact National For 2700K Option	<input type="checkbox"/> T <input type="checkbox"/> F <input type="checkbox"/> SG <input type="checkbox"/> T1	<input type="checkbox"/> 120 V <input type="checkbox"/> 277 V <input type="checkbox"/> UNIVERSAL	<input type="checkbox"/> EM <input type="checkbox"/> 0-10V <input type="checkbox"/> DALI <input type="checkbox"/> LDE1 - Eco1% <input type="checkbox"/> L3DA-3Wire or Eco1% <input type="checkbox"/> SENSOR(OCC/VAC) <input type="checkbox"/> TAILS

LUMENS WILL VARY
DEPENDING ON DIFFUSER
AND LED COLOR TEMP.

NATIONAL 3E/LED SERIES USES ENGINE/STICK ORIGINAL EQUIPMENT (BY OSRAM, PHILIPS, SAMSUNG, ET AL) WHICH ARE RATED FOR APPROXIMATELY 150 LM/W. ARCHITECTURAL LENSES PROVIDED WITH THE LUMINAIRES BY DESIGN EVEN THE BRIGHTNESS AND VISUAL COMFORT AND MIGHT FRACTIONALLY LOWER LM/W.

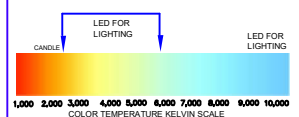

522 CORTLANDT ST.
BELLEVILLE, NJ 07109

NJ 973-751-1600
NY 212-751-1600
FAX 973-751-4931
WWW.NATLTG.COM



AFFINE2X2 LED

PHOTOMETRIC DATA

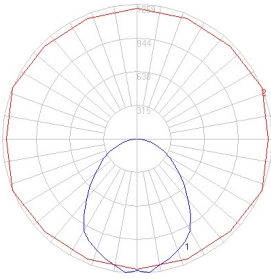

AFFINE 2X2 LED-LO

LIFE: 60,000 HRS
 WATTS:26
 LUMENS:2457
 EFFICACY:94.5
 CRI: 80+

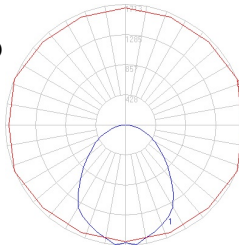

AFFINE 2X2 LED-MO

LIFE: 60,000 HRS
 WATTS:38
 LUMENS:3520
 EFFICACY:92
 CRI: 80+

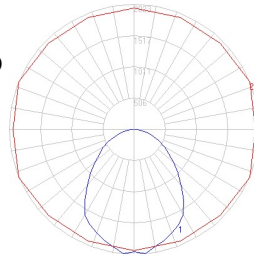

AFFINE 2X2 LED-HO

LIFE: 60,000 HRS
 WATTS:45.02
 LUMENS:4256
 EFFICACY:94.05
 CRI: 80+

MOUNTING INSTRUCTIONS

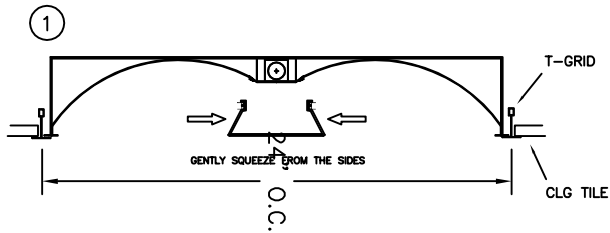

ABOVE CEILING STRUCTURE AND SUPPORT TO BE SUPPLIED BY OTHERS.

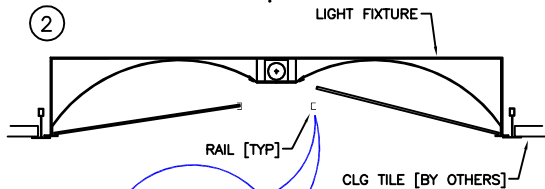

NOTE: ALL PLASTIC SIDE PANELS ARE TO BE FIELD INSTALLED BY OTHERS.

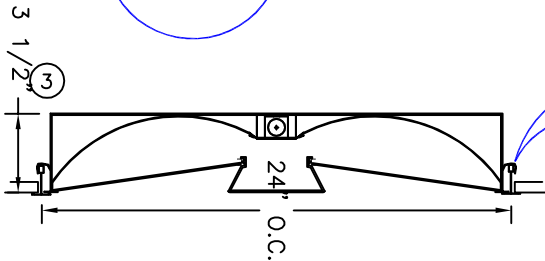
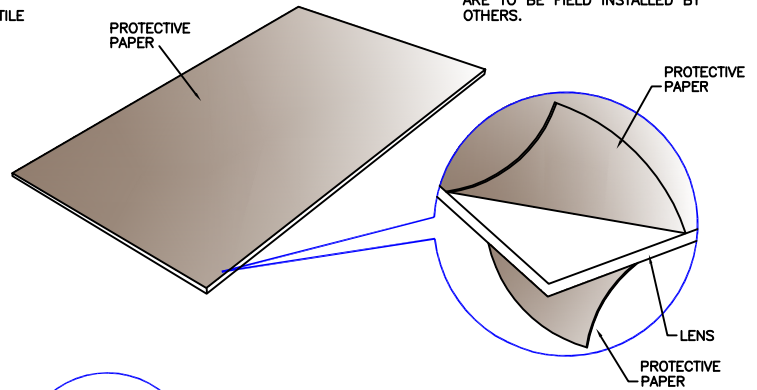
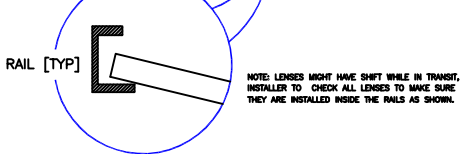

FOR E.Q. CLIP BEND TABS AS SHOWN (TYPICAL)

LIGHTING CONTROL SOLUTIONS

1. DIMMING (0-10V, DALI Or Lutron)
 - 0-10V Dimming Driver used as standard.
 - Continuous Dimming up to 10%.
 - Dimming wires not provided unless specified
 - Contact National for Dali or Lutron Control system
2. Occ/DAYLIGHT/Vacancy/Bi-Level
 - Sensor-ready and compatible drivers provided.
 - Sensors can be field installed or could be installed in the fixtures
 - Bi-level dimming and Motion sensors also available
3. Compatibility:
 - National fixtures are compatible with Lutron, Philips Actilume, Magnum, Wattstopper, Hubbell , Leviton , Hytronik , Daintree & Enlighted Control System

GREENFIELD OPTIONS

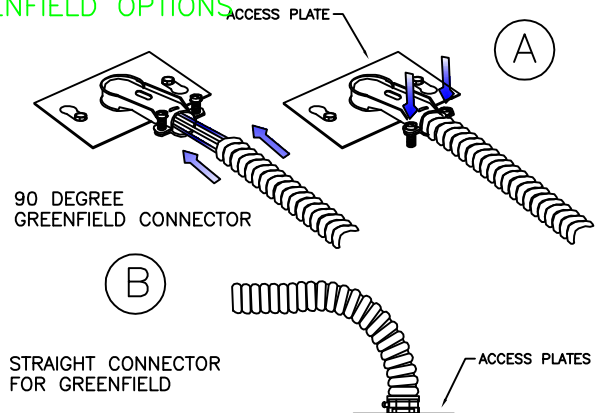

NATIONAL LIGHTING COMPANY, INC.
 522 CORTLANDT ST.
 BELLEVILLE, NJ 07109

NJ 973-751-1600
 NY 212-751-1600
 FAX 973-751-4931
 WWW.NATLTG.COM

JOB NAME:
CATALOG:
TYPE: